

Encapsulated Sanitary 3 Piece Stainless Steel Ball Valve

- full port design offers lower pressure drop and a less turbulent flow
- blow-out proof stem
- live-loaded stem packing
- CF8M stainless body, ends and ball
- ISO 5211 mounting pad
- lock-out, tag out
- non-encapsulated also available
- rated to 1/2" - 2" **1,000 PSI WOG**
2 1/2" - 4" **800 PSI WOG**

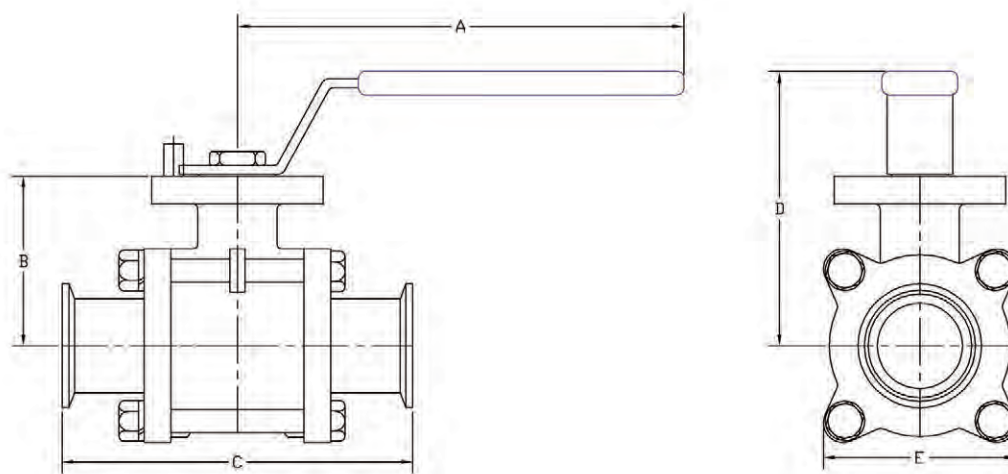

Size	A	B	C	D	E
1/2"	4.9	1.5	4.3	3	1.9
3/4"	4.9	1.8	4.7	3.3	2.2
1"	5.6	2.1	4.9	3.6	2.4
1 1/2"	9.5	2.7	5.6	4.4	3.1
2"	9.5	3.1	6.4	4.8	3.7
2 1/2"	18.0	3.8	7.8	5.2	4.8
3"	18.0	4.2	9	5.7	5.4
4"	18.0	5.3	9.5	6.8	8.8

Dimensions are approximate. Engineering dimensions are available upon request.
Specifications are subject to change without notice.

Handle Kits

Size	Part Number
1/2" - 3/4"	BV-23-HA050-075
1"	BV-23-HA100
1 1/2" - 2"	BV-23-HA150-200
2 1/2"	BV-23-HA250
3" - 4"	BV-23-HA300-400

kit contains:
(1) lock washer
(1) handle
(1) nut

- custom handle covers available, see page 177

Repair Kits

kit contains:
(1) O-ring
(1) thrust washer
(3) stem packings
(2) encapsulated seats
(2) body seals

- see page 164 for part numbers

Encapsulated Sanitary 3 Piece Stainless Steel Ball Valve

Size	Ball Valve Part #	Repair Kit Part #	Break Torque (in-lb)	Code ID	Seat material
½"	BV2CV-050CC-A	BV-2C-VK050	31	V	Virgin PTFE
¾"	BV2CV-075CC-A	BV-2C-VK075	47		
1"	BV2CV-100CC-A	BV-2C-VK100	105		
1½"	BV2CV-150CC-A	BV-2C-VK150	238		
2"	BV2CV-200CC-A	BV-2C-VK200	256		
2½"	BV2CV-250CC-A	BV-2C-VK250	900		
3"	BV2CV-300CC-A	BV-2C-VK300	1650		
4"	BV2CV-400CC-A	BV-2C-VK400	2027		
½"	BV2CG-050CC-A	BV-2C-GK050	34	G	15% glass reinforced TFE
¾"	BV2CG-075CC-A	BV-2C-GK075	51		
1"	BV2CG-100CC-A	BV-2C-GK100	116		
1½"	BV2CG-150CC-A	BV-2C-GK150	261		
2"	BV2CG-200CC-A	BV-2C-GK200	281		
2½"	BV2CG-250CC-A	BV-2C-GK250	990		
3"	BV2CG-300CC-A	BV-2C-GK300	1815		
4"	BV2CG-400CC-A	BV-2C-GK400	2229		
½"	BV2CC-050CC-A	BV-2C-CK050	37	C	25% carbon reinforced TFE
¾"	BV2CC-075CC-A	BV-2C-CK075	57		
1"	BV2CC-100CC-A	BV-2C-CK100	127		
1½"	BV2CC-150CC-A	BV-2C-CK150	287		
2"	BV2CC-200CC-A	BV-2C-CK200	309		
2½"	BV2CC-250CC-A	BV-2C-CK250	1089		
3"	BV2CC-300CC-A	BV-2C-CK300	1997		
4"	BV2CC-400CC-A	BV-2C-CK400	2452		
½"	BV2CS-050CC-A	BV-2C-SK050	41	S	50% stainless steel reinforced TFE
¾"	BV2CS-075CC-A	BV-2C-SK075	62		
1"	BV2CS-100CC-A	BV-2C-SK100	140		
1½"	BV2CS-150CC-A	BV-2C-SK150	316		
2"	BV2CS-200CC-A	BV-2C-SK200	340		
2½"	BV2CS-250CC-A	BV-2C-SK250	1198		
3"	BV2CS-300CC-A	BV-2C-SK300	2196		
4"	BV2CS-400CC-A	BV-2C-SK400	2698		
½"	BV2CU-050CC-A	BV-2C-UK050	31	U	UHMW
¾"	BV2CU-075CC-A	BV-2C-UK075	47		
1"	BV2CU-100CC-A	BV-2C-UK100	105		
1½"	BV2CU-150CC-A	BV-2C-UK150	238		
2"	BV2CU-200CC-A	BV-2C-UK200	256		
2½"	BV2CU-250CC-A	BV-2C-UK250	900		
3"	BV2CU-300CC-A	BV-2C-UK300	1650		
4"	BV2CU-400CC-A	BV-2C-UK400	2027		

U

Ball
Valves

Technical Information

Seal Materials

Code	Designation	Material	Applications
V	Virgin PTFE	Virgin polytetrafluoroethylene	100% PTFE- Our standard seat material. Ideal for most sanitary services. Specified for applications requiring a low co-efficient of friction. Food Grade Material
G	RTFE	15% glass reinforced tetrafluoroethylene	15% glass filled + 85% PTFE - Slightly higher temperature and pressure rating than PTFE. Specified for applications requiring higher cycle life than PTFE. Food Grade Material
C	25% Carbon PTFE	25% carbon reinforced tetrafluoroethylene	25% carbon +75% PTFE - Specified for higher temperature pressure applications. Ideal for steam and thermal fluid applications. Higher cycle life than RTFE.
S	Stainless Steel PTFE	50% stainless steel filled tetrafluoroethylene	50% stainless steel + 50% PTFE - Specified for higher temperature pressure applications in a sanitary process. Food Grade Material
U	UHMW	Ultra-high molecular weight polyethylene	Specified for its low modulus of abrasion and minimal property degradation when exposed to moderate levels of radiation. Ideal for applications where fluorocarbons are not acceptable. Food Grade Material

Pressure Temperature Charts

